

**Mobile Shock Warning:** NEVER BEND DIRECTLY TO THE MUZZLE WHICH TAKE NO NOTICE OF THE SAFETY RULES, OR DO NOT CHANGE SHOCK WHEN FIREARM IS LOADED. ABSOLUTELY DO NOT FIRE WHEN THE MOBILE SHOCK DOES NOT FIT COMPLETELY AND TIGHTLY TO THE UNIT OF THE GROOVE, DO NOT SHOOT IF SHOCK OR BARREL GROOVE CORRUPTION. OTHERWISE, BARREL DAMAGES.

MOBILE SHOCK WHICH NOT FITTED THE BARREL WELL CAN CAUSE DEATH, INJURY OR OTHER DAMAGES. DO NOT SHOOT WITHOUT MOBILE SHOCK IN THE MUZZLE. IN SUCH A CASE, IT WILL BE UNPREDICTABLE HOW THE PELLETS WILL DISPERSE. IN ADDITION TO THIS, GROOVE WILL BE CORRUPTED WHICH IS INSIDE OF THE BARREL. NO SHOCK WILL BE ATTACHED AND THE REPAIR WILL BE VERY EXPENSIVE FOR YOU.

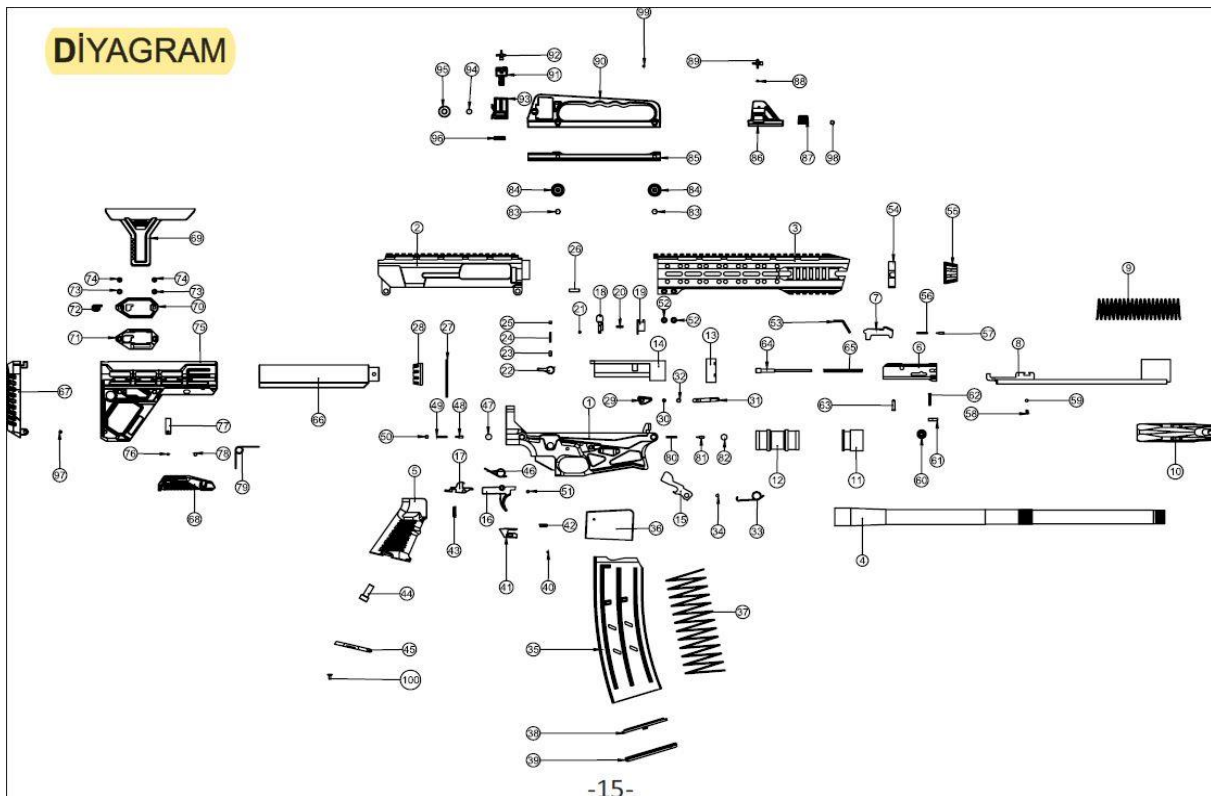

DIAGRAM LIST			
1	Lower Receiver	51	Trigger Pin
2	Upper Receiver	52	Handguard screw
3	Fore end	53	Front belting
4	Barrel	54	Handguard cap
5	Grip	55	Square nut

<b>6</b>	Mechanism	<b>56</b>	Extractor Spring
<b>7</b>	Mechanism lock	<b>57</b>	Extractor Pin
<b>8</b>	Mechanism lever	<b>58</b>	Cocking Lever Holder Ball Spring
<b>9</b>	Recoil spring	<b>59</b>	Cocking Lever Holder Ball
<b>10</b>	Muzzle	<b>60</b>	Cocking Lever
<b>11</b>	Gas piston	<b>61</b>	Extractor
<b>12</b>	Gas piston	<b>62</b>	Extractor Pin
<b>13</b>	Barrel bushing	<b>63</b>	Needle Holder
<b>14</b>	Bearing Cap	<b>64</b>	Needle
<b>15</b>	Hammer	<b>65</b>	Needle Spring
<b>16</b>	Trigger	<b>66</b>	Telescopic stock rail
<b>17</b>	Inner Trigger	<b>67</b>	Telescopic stock rubber
<b>18</b>	Mechanism Holder	<b>68</b>	Telescopic stock latch
<b>19</b>	Mechanism Holder Receiver	<b>69</b>	Telescopic stock Cheek Piece
<b>20</b>	Mechanism Holder pin	<b>70</b>	Telescopic stock Cheek piece left slot
<b>21</b>	Mechanism Holder Spring	<b>71</b>	Telescopic stock Cheek piece right slot
<b>22</b>	Safety	<b>72</b>	Telescopic stock Cheek Piece latch
<b>23</b>	Safety pin	<b>73</b>	Telescopic stock Cheek Piece screw
<b>24</b>	Safety Spring	<b>74</b>	Telescopic stock Cheek Piece nut
<b>25</b>	M5 Propeller Screw	<b>75</b>	Telescopic stock receiver
<b>26</b>	Handguard guide pins	<b>76</b>	Telescopic stock latch pin
<b>27</b>	Rear belting	<b>77</b>	Telescopic stock adjustment pin
<b>28</b>	Stock Bushing	<b>78</b>	Telescopic stock spring pin
<b>29</b>	Magazine unload latch	<b>79</b>	Telescopic stock latch spring
<b>30</b>	Magazine unload latch screw	<b>80</b>	Frontier Disassemble Pin Holder Spring
<b>31</b>	Magazine Catch	<b>81</b>	Frontier Disassemble Pin Holder
<b>32</b>	Magazine Unload Latch Spring	<b>82</b>	Frontier Disassemble Pin
<b>33</b>	Hammer Spring	<b>83</b>	Carrying Handle Screw
<b>34</b>	Hammer pin	<b>84</b>	Carrying Handle Nut
<b>35</b>	Magazine	<b>85</b>	Carrying Handle Side cap
<b>36</b>	Magazine Follower	<b>86</b>	Front sight receiver
<b>37</b>	Magazine Spring	<b>87</b>	Front sight latch
<b>38</b>	Magazine Base Plate Retainer	<b>88</b>	Front sight pin
<b>39</b>	Magazine Base Plate	<b>89</b>	Front sight revolving rear sight
<b>40</b>	Magazine Follower Catch pin	<b>90</b>	Carrying Handle Receiver
<b>41</b>	Magazine Follower Catch	<b>91</b>	Carrying Handle rear sight
<b>42</b>	Magazine Follower Catch Spring	<b>92</b>	Carrying Handle revolving rear sight
<b>43</b>	Inner Trigger Spring	<b>93</b>	Carrying Handle side adjustment rear sight
<b>44</b>	Grip Binding Screw	<b>94</b>	Carrying Handle side adjustment rear sight pin
<b>45</b>	Grip Cap	<b>95</b>	Carrying Handle side adjustment rear sight nut
<b>46</b>	Trigger Spring	<b>96</b>	Carrying Handle rear sight nut
<b>47</b>	Rear Disassemble pin	<b>97</b>	Telescopic stock rubber pin
<b>48</b>	Rear Disassemble pin holder	<b>98</b>	Fore sight latch spring
<b>49</b>	Rear Disassemble pin holder spring	<b>99</b>	Carrying Handle revolving rear sight pin
<b>50</b>	Pin holder propeller screw	<b>100</b>	Grip screw